

1 Taking care of your device

Your device is a product of superior design & craftsmanship and should be handled with care: The following recommendations will help protect your phone:

- Keep the device dry. Precipitation, humidity, and all types of liquid or moisture may contain minerals that can rust electronic circuits. Shut down the phone when it suffered water damage (Do not pull out the battery) ,and boot up the phone after it is dry.
- Do not expose your phone to extreme temperatures lower than 0°C and higher than 45°C.
- Do not use or store device in dusty and dirty areas; the electronic components may be damaged.
- Do not attempt to open device in any way other than instructed in this guide. Repairs attempted by an entity other than designated service agent/center will void warranty.

CAUTION: Android is a trademark of Google Inc.

Licking the charger is strictly prohibited; saliva is more corrosive than water. Residual saliva may short-circuit phone and damage its motherboard, causing the device to become inoperable; battery & charger may also be damaged in the process.



WARNING:

Licking USB plug is strictly prohibited.

- Do not drop, knock, or shake device. Rough handling can disrupt internal circuit boards and fine mechanical parts.
- Do not use harsh chemicals, cleaning solvents, or strong detergents to clean the device. Use a soft and dry cloth to wipe down surfaces.

Battery & charger safety

- Do not place battery in fire, explosion may occur. With concern for the environment, please abide local laws & ordinances in battery disposal.
- Only use original battery, charger, and accessories applicable to the specific mobile model. Failure to do so voids the warranty and may result in a hazard.
- Power off mobile prior to testing its charger. If charger malfunctions, off-mode will prevent damage to the motherboard.
- Please keep the charging mobile away from small children.
- Do not touch charger or mobile with wet hands; it's hazardous and may damage electronic parts.
- The physicochemical processes created by chargers impose temperature limits when charging the battery. Your phone automatically protects the batteries in extreme temperatures.

WARNING:

- Risk of explosion if original battery is replaced.
- Tampering with mobile OS and ROOT voids warranty and may cause software instability.

2 Know your phone

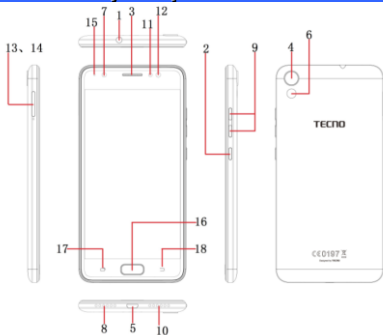

- | | |
|----------------------------|---------------------------------|
| 1. Earphone plug | 2. Power button |
| 3. Receiver | 4. Rear camera |
| 5. USB port | 6. Flash |
| 7. Front camera | 8. Microphone |
| 9. Volume button | 10. Speaker |
| 11. Light/proximity sensor | 12. Front flash |
| 13. SIM card slot | 14. T-card slot |
| 15. Blinking light | 16. Home key/Fingerprint ID key |
| 17. Recents key | 18. Back key |

3 SIM / SD card installation

1. Refer to the following picture for SIM / SD card installation.

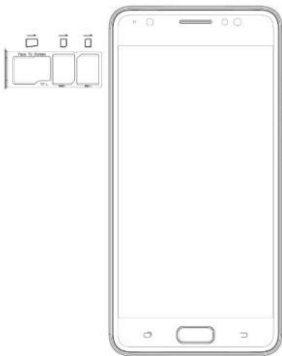

4 Home screen

Home screen showcases frequently used apps, you can also display ubiquitous information such as time, weather (third-party app required), date, etc.



5 Dialing

Tap the phone icon to open call interface. Enter contact number via keypad to start a call. The keypad interface also enables functions such as texting and contact storage.

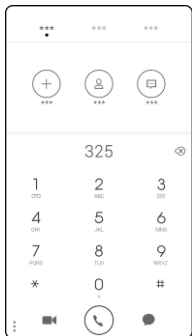

6 Notification & function toggle

The notification screen displays new information & events; simply tap the notification to access its detailed content.

The function-toggle screen lists commonly used functions and their virtual switches. Tap a switch to quickly turn a function on/off.

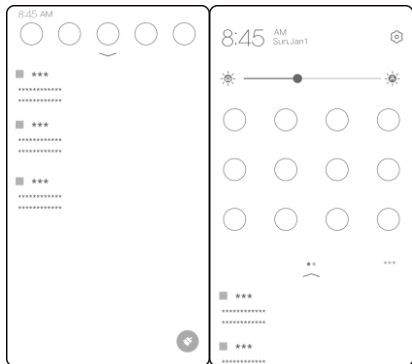

7 Messages

The message function sends plain or multimedia texts to your friends. Tap a message to view its content. Tap the “Compose new message” button to start composing a message and send it to designated contact.

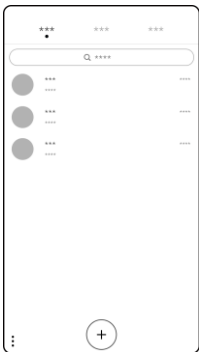

8 Camera

The camera function captures your surroundings via the front or rear camera. Various types of white balance and photo filters are available to accommodate different lighting conditions.



9 My picture

My picture can be used to browse images and photos from mobile or SD card storage; editing functions can be performed. Images can be designated as wallpaper or contact avatar. The sharing function allows images to be shared with friends via Bluetooth and MMS, etc.



10 Wi-Fi

Enabling Wi-Fi grants access to local hotspots and allows you to browse Internet. Private networks will require a password.

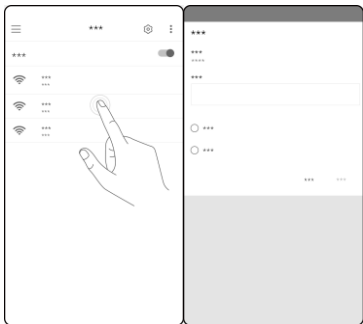

11 Music

Music playlist displays all relevant files saved on the mobile or SD card storage. You can play, pause, and switch between tracks through the music control panel. Volume control is accessed via side buttons.

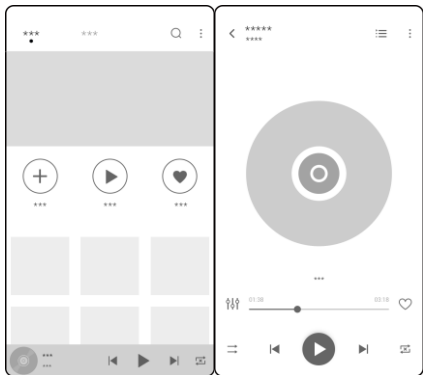

12 Aha

Aha is a virtual software store that offers commonly used apps. Simply tap an app to start downloading.



13 Factory data reset

“Factory data reset” resets all configurations to their default state. Internal mobile storage is cleared of all data including apps, photos, music, videos, mail, contacts, etc. This procedure may take a long time. Please wait patiently for mobile to restart and do not power off.

WARNING:

Factory data reset as a last resort. Once activated all user data & configurations are deleted and cannot be restored.

14 SAR

The highest SAR value for this mobile phone is $< 1.6 \text{ W/Kg}$, in accordance with the requirements of the ICNIRP, which recommended the limit for exposure to radio waves to be 1.6 watts/kilogram(W/kg) averaged over 1 gram of human tissue.

Safety precautions:

- a) Use a wireless hands-free system (headphone, headset) with a low power Bluetooth emitter.
- b) Make sure the cell phone has a low SAR.
- c) Keep your calls short or send a text message (SMS) instead. This advice applies especially to children, adolescents and pregnant women.
- d) Use cell phone when the signal quality is good.
- e) People having active medical implants should preferably keep the cell phone at least 15 cm away from the implant.

15 RoHS

We at tecno take our social responsibility seriously and are committed to the cause of saving our environment, it is in keeping with these commitments that we are proud to state that tecno phones are RoHS compliant.

16 E-Waste, recycle your phone



The WEEE logo (shown at the left) appears on the product (battery, handset, and charger) to indicate that this product must not be disposed off or dumped with your other household wastes. You are liable to dispose of all your electronic or electrical waste equipment by relocating over to the specified collection point for recycling of such hazardous waste.

Collection and proper recovery of your electronic waste equipment at the time of disposal will allow us to help preserve the environment. Recycling of the electronic waste equipment will ensure safety of human health and environment.

INFORMATION UNDER E-WASTE (MANAGEMENT AND HANDLING) RULES, 2011

For disposal of e-waste, please call our helpline number or visit our website.

E-waste Helpline number: 18004190525

Website: www.tecno-mobile.com

1. Do's for disposal of product

a) Always drop your used electronic products, batteries, and packaging materials after the end of their life in the

nearest collection point or collection center

b) Separate the packaging material according to responsible waste disposal options and sorting for recycling.

c) The battery can easily be removed from the product for recycling.

2. Don't of disposal of equipment

a) Never dump E-waste in garbage bins or municipal solid waste stream.

b) Do not dispose of your product as unsorted municipal waste.

c) Do not throw used batteries into household waste.

d) Do not dispose damaged or leaking Lithium Ion (Li-ion) battery with normal household waste.

3. Information on the consequences of improper handling, accidental breakage damage and improper recycling of the end of life product.

a) If batteries are not properly disposed of, it can cause harm to human health or the environment.

b) Placing of batteries or devices on or in heating devices, such as microwave ovens, stoves, or radiators and improper disposal of batteries may lead to explosion.

c) If the battery terminals are in contact with metal objects, it may cause a fire.

17 Battery recommendations

- Please put the battery in a well-ventilated place out of direct sunlight. Charge the battery at room temperature range.

- If the time span of the battery after charging becomes much shorter than usual, the battery life is at an end. Replace the battery with a new battery of the same make and specification.
- Do not discard the battery with household trash. Please ensure you dispose of used battery according to your local environmental laws and guidelines.
- Use manufacturer approved batteries, chargers, accessories and supplies. We will not be responsible for user's safety when using unapproved batteries or accessories.

18 Disclaimers

- The colors and specifications shown/mentioned in the user manual may differ from the actual product. Images shown are for representation purpose only.

Other product logos and company names mentioned herein may be trademarks or trade names of their respective owners.

- The content of this manual may vary from the actual content displayed in the mobile phone. In such a case, the later shall govern.
- We keep the right to make modifications to any of the content in this user guide without public announcement or prior notification.
- For devices with external power supplies, plug socket should be placed in short distance and easily accessible.
- Using the wrong type of battery replacement may cause a danger of explosion, be sure to follow the instructions disposal of used batteries.

19 Copyrights

All rights reserved. Reproduction, transfer, distribution or storage of part or all of the contents in this document in any form without the prior written permission is strictly

prohibited.

WARNING:



To prevent possible hearing damage, do not listen at high volume levels of long periods.

Use the device only with the earphones included, never change the earphones included for another one.